



# SCREWED END SWING CHECK VALVE

# 2030

## FEATURES



- 1/2"~3" (DN15~DN80)
- W.P. : 200 WOG
- W.T. : -20°C~200°C (-4°F~392°F)
- Investment casting
- Socket weld (option)
- Thread type : ASME B1.20.1 (NPT)  
DIN2999 & BS21  
ISO7/1 & EN10226

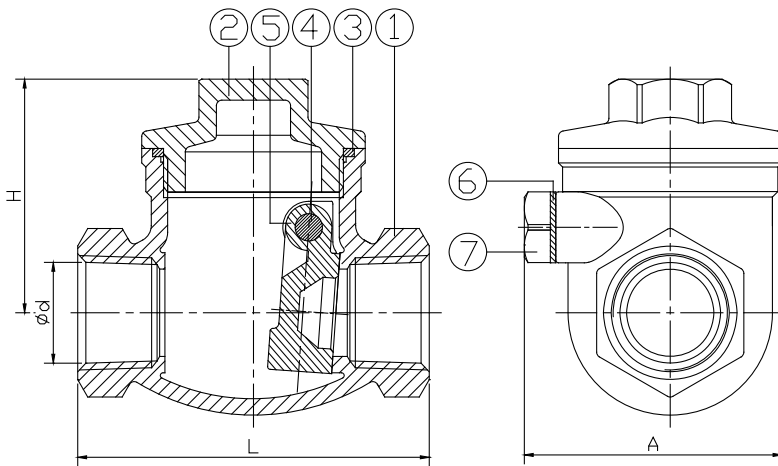

ITEM	PARTS	MATERIAL	
1	BODY	ASTM A351-CF8M	ASTM A351-CF8
2	CAP		
3	SEAL	PTFE	
4	PLUG	AISI 316	AISI 304
5	DISC	ASTM A351-CF8M	ASTM A351-CF8
6	GASKET	PTFE	
7	BOLT	AISI 304	

DN	d	L	H	A	Weight (kg)
15	16	65	43	46.5	0.3
20	20	80	51	51.5	0.4
25	25	89	60	56	0.7
32	32	105	66	64	1
40	40	120	75	74.5	1.6
50	50	139	80	84	2.1
65	65	181	99	105	4.6
80	80	200	104	140	7.6

unit:mm

NPS	d	L	H	A	Weight (lb)
1/2"	0.63	2.56	1.69	1.83	0.7
3/4"	0.79	3.15	2.01	2.03	1
1"	0.98	3.5	2.36	2.2	1.5
1-1/4"	1.26	4.13	2.6	2.52	2.2
1-1/2"	1.57	4.72	2.95	2.93	3.4
2"	1.97	5.47	3.15	3.31	4.7
2-1/2"	2.56	7.13	3.9	4.13	10.1
3"	3.15	7.87	4.09	5.51	16.7

unit:in



8F, No.201, Sec. 2, Tiding Blvd., Neihu District, Taipei City 114, Taiwan R.O.C.  
 TEL: +886-2-2658-5800 FAX: +886-2-2658-2266 / 2799-7766

E-mail : [haitima@seed.net.tw](mailto:haitima@seed.net.tw)  
<http://www.haitima.com.tw>